

REV	DESCRIPTION	DRAWN	DATE

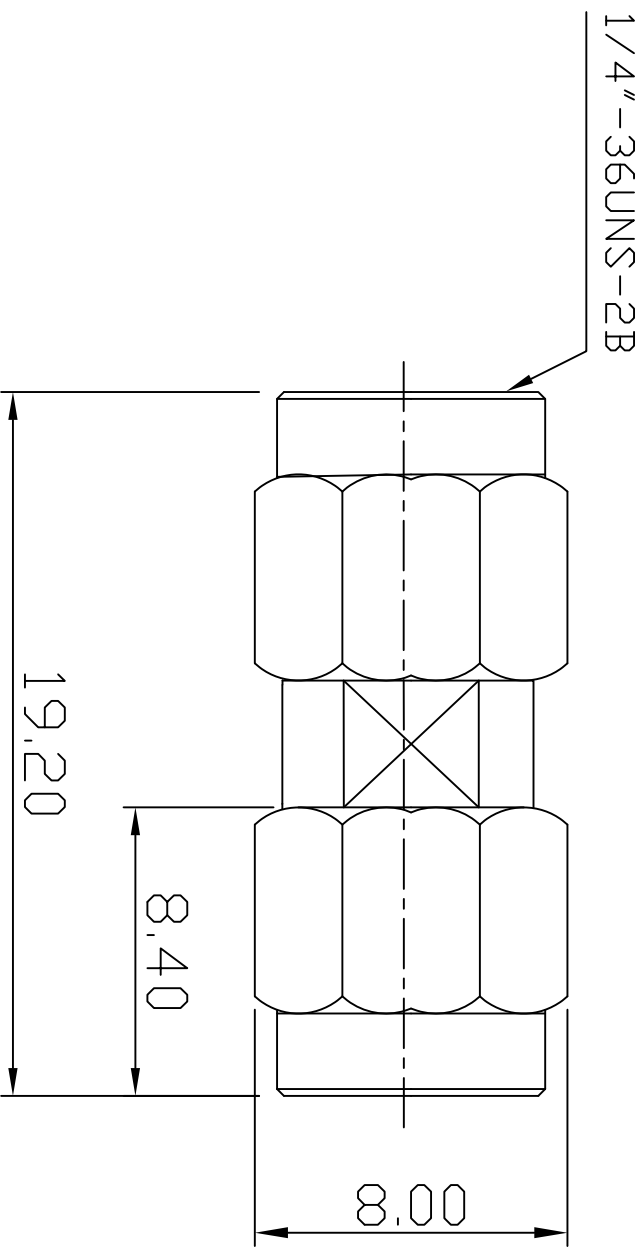

NO	Description	Qty	Material	Finish
1	Body(B-00037)	1	BRASS	GOLD
2	Pin(C-00040)	1	BRASS	GOLD
3	Dielectric(T-00030)	2	TEFLON	NONE
4	Shell(S-004)	2	BRASS	GOLD
5	Retaining ring(W-007)	2	BRASS	GOLD
6	Gasket(G-002-S1)	2	SI-rubber	NONE

R&D

*MAJOR DIMENSION
 UNLESS OTHERWISE NOTED TOLERANCES
 0.5-6=±0.2
 6-30=±0.4
 30-120=±0.6
 120-315=±1.0
 ANGLES=±1.0

SCALE 4/1 UNIT MM

APPROVED	CHECKED	DRAWN
CASH	LYDIA	CASH

RF CASTLE 華城電子有限公司
 RF CASTLE ELECTRONICS CO.,LTD

TITLE
 SMA DOUBLE MALE

DRAWING NO.
 SMA-1049-2-TGG

REV
 LY A

DRAWN DATE 08/10/23